

For SEL Controller
Teaching box

SEL-T/TD



1 ANSI robot standard / Safety category compliant

SEL-TD is equipped with a 3-position enable switch compatible with ANSI robot standard. In addition, the emergency stop switch is able to respond to safety category class 4 by making circuits redundant.

2 Improved environmental resistance (Protective structure IP54)

Due to IP54's protective structure, use in hostile environments is possible, where the likes of dust and the water spray are present.

3 Expanded range of safety functions

Can be used outside Japan due to CE/UL standard compatibility.



SEL controller
teaching box

SEL-T
(Standard specification)

SEL-TD
(ANSI handling specification)



Specification

Item	Details			
	SEL-T	SEL-TD	SEL-T-J	SEL-TD-J
Connector converter cable (※1)	Not Required		Attached	
3—position enable switch	No	Yes	No	Yes
ANSI specification	Non-compliant	Compliant	Non-compliant	Compliant
CE mark, UL specification	Compliant			
Corresponding controller (※2)	 XSEL (※ Excluding J / JX type)		 TT	
Position input	○			
Programming input	○			
Parameter rewrite	○			
Each type of stator	○			
Display	20 characters × 4 lines			
Operating ambient temperature & humidity	0-40°C		10-90%RH (Non condensing)	
Protective structure	IP54			
Cable length	5m			
Mass	Approx. 0.4kg (Excluding cable)			

(※ 1) A connector converter cable is required when connecting SEL-T / SEL-TD to PSEL, ASEL, SSEL.

Connector converter cable type: CB-SEL-S J002 (Cable length: 0.2m)

(※ 2) XSEL-J / JX type controller cannot be used.

Outline View

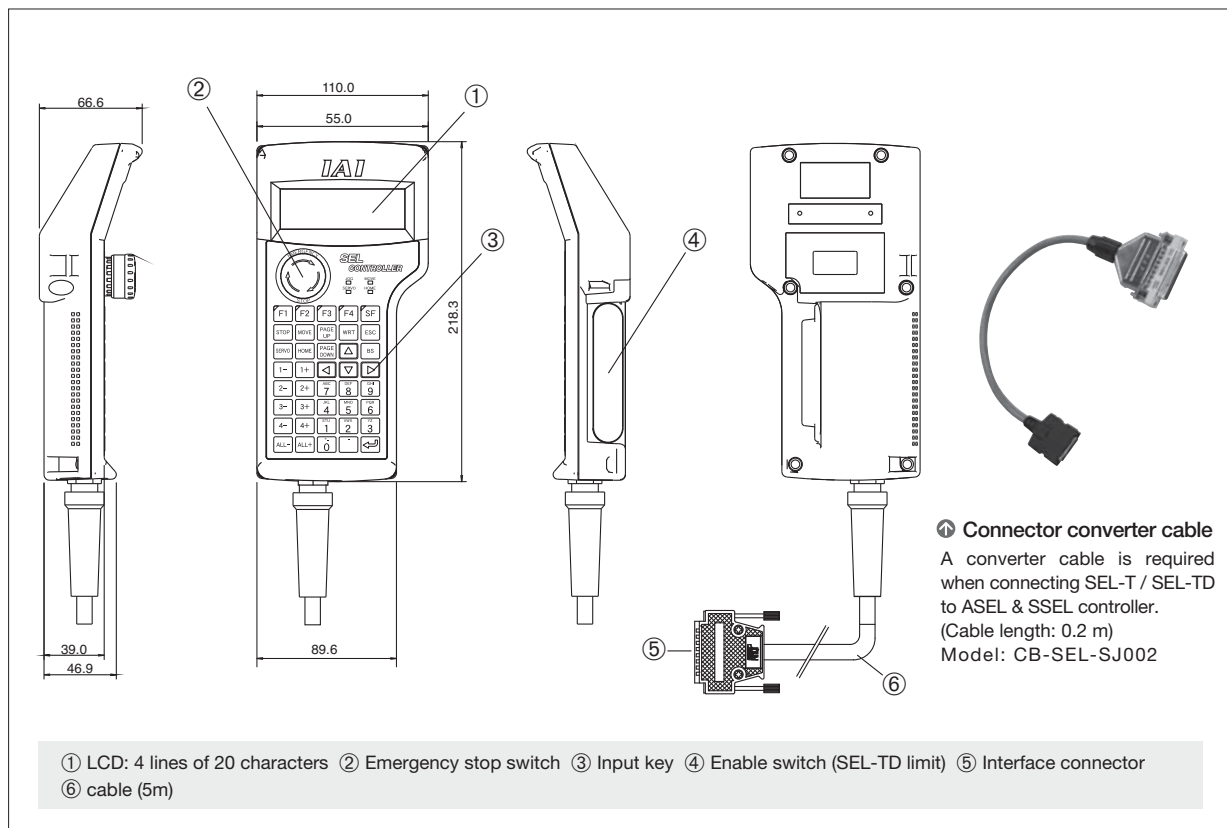

IAI America, Inc.

Head Office 2690 W 237th Street, Torrance, CA 90505
 Chicago Office: 1261 Hamilton Parkway Itasca, IL 60143
 Atlanta Office: 1220 Kennestone Circle Suite E, Marietta, GA 30066

Website: www.intelligentactuator.com

The information contained in this catalog is subject to change without notice for the purpose of product improvement.

IAI Industrieroboter GmbH

Ober der Röth 4, D-65824 Schwalbach am Taunus, Germany

