

Options Available per Model

			Option Symbol																
			Cable Exit Direction									Brake				No Brake Box*	With Cover	Flange Bracket	Front Flange
			A1	A2	A3	CJT	CJR	CJL	CJB	CJO	K2	B	BE	BL	BR	BN	CO	FB	FL
Slider Type	RCP3	SA2□C				●	●	●	●			●							
		SA3/4/5/6C				●	●	●	●			●							
		SA2□R				●			●	●		●							
	RCP2	SA3/4/5/6R				●			●	●		●							
		SA5/6/7C										●	●	●					
		SS7/SS8/HS8C										●							
		SA5/6/7R										●							
	RCA2	SS7/SS8/HS8R										●							
		BA6/7										●							
	RCA	SA3/4/5/6C				●	●	●	●			●							
		SA3/4/5/6R				●			●	●		●							
	RCS2	SA4C										●							
		SA5/6C										●							
		SA4D										●	●	●					
		SA5/6D										●	●	●					
		SA4R										●							
		SA5/6R										●							
	Rod Type	RCP3	SA4R									●							
SA5/6R											●								
RCP2		SA7C									●	●	●						
		SS7/8C									●								
		SA4D									●	●	●						
RCA		SA5/6D									●	●	●						
		SA4R									●								
		SA5/6R									●								
		SA7R									●								
RCS2		SS7/8R									●								
	RA2□C									●									
	RA2□R									●									
	RA2C									●									
	RA3C									●									
	RA4/6C									●									
	RA10C	●	●	●						●									
	SRA4R									●									
Table/Arm/Flat Type	RCP3	RN/RP/GS/GD□N								●									
		SD□N									●								
	RCA	RA3/4C									●								
		RA3/4D									●								
		RA3/4R									●								
		SRA4R									●								
	RCS2	RA4C				●					●								
		RA5C				●					●								
		RA4D									●	●	●						
		SRA7BD	●	●	●						●								
RA4R										●									
RA5R										●									
Gripper Type	RCP2	RA13R									●			●					
		TA3C									●								
	RCA2	TA4/5/6/7C				●	●	●	●			●							
		TA3R				●			●	●		●							
TA4/5/6/7R					●	●	●	●		●									
RCS2	TC/TW/TF□N				●	●	●	●		●									
	TA4/5/6/7R				●			●	●		●								
Rotary Type	RCP2	A4/5/6R									●								
		A4/5/6R									●								
Linear Servo Type	RCL	F5D									●								
		GR□□/GR3□□														●			
Cleanroom Type	RCP2CR	RT□□																	
		RT□□L																	
	RCS2CR	RT6/RT6R/RT7R																	
		SA4/5/6L									●			●					
		SA4/5/6C									●	●	●	●					
		SS7/SS8/HS8C									●								
Splash-Proof	RCP2W	SA4C									●								
		SA5/6C									●								
	RCAW	SA5/6D									●	●	●						
		SA4C									●								
	RCS2W	SA5/6C									●								
		SA7C									●	●	●						
		SS7/8C								●									
		SA5/6D								●	●	●							

* Spare part order only

Option Symbol																										
	Rear Flange	Foot	Foot (Right, Left)	High Acceleration/Deceleration	Home Sensor	Limit Switch	Power Saving	No Cover	Reversed-home	Knuckle Joint	Clevis	Side-Mounted Motor Orientation				Rod Extension	Rear Mounting Plate	Shaft Adapter	Shaft Bracket	Slider Roller	Slider Spacer	Table Adapter	Front Trunnion	Rear Trunnion	Vacuum Joint On Opposite Side	
	FLR	FT	FT□	HA	HS	L	LA	NCO	NM	NJ	QR	MB	ML	MR	MT	RE	RP	SA	SB	SR	SS	TA	TRF	TRR	VR	
								●	●					●	●											
								●	●					●	●											
									●					●	●						●					
									●					●	●						●					
									●					●	●						●					
									●					●	●						●					
									●					●	●						●					
									●					●	●						●					
									●					●	●						●					
									●					●	●						●					
									●					●	●						●					
									●					●	●						●					
									●					●	●						●					
									●					●	●						●					
									●					●	●						●					
									●					●	●						●					
									●					●	●						●					
									●					●	●						●					
									●					●	●						●					
									●					●	●						●					
									●					●	●						●					
									●					●	●						●					
									●					●	●						●					
									●					●	●						●					
									●					●	●						●					
									●					●	●						●					
									●					●	●						●					
									●					●	●						●					
									●					●	●						●					
									●					●	●						●					
									●					●	●						●					
									●					●	●						●					
									●					●	●						●					
									●					●	●						●					
									●					●	●						●					
									●					●	●						●					
									●					●	●						●					
									●					●	●						●					
									●					●	●						●					
									●					●	●						●					
									●					●	●						●					
									●					●	●						●					
									●					●	●						●					
									●					●	●						●					
									●					●	●						●					
									●					●	●						●					
									●					●	●						●					
									●					●	●						●					
									●					●	●						●					
									●					●	●						●					
									●					●	●						●					
									●					●	●						●					
									●					●	●						●					
									●					●	●						●					
									●					●	●						●					
									●					●	●						●					
									●					●	●						●					
									●					●	●						●					
									●					●	●						●					
									●					●	●						●					
									●					●	●						●					
									●					●	●						●					
									●					●	●						●					
									●					●	●						●					
									●					●	●						●					
									●					●	●						●					
									●					●	●						●					
									●					●	●						●					
									●					●	●						●					
									●					●	●						●					
									●					●	●						●					
									●					●	●						●					
									●					●	●						●					
									●					●	●						●					
									●					●	●						●					
									●					●	●						●					
									●					●	●						●					
									●					●	●						●					
									●					●	●						●					
									●					●	●						●					
									●					●	●						●					
									●					●	●						●					
									●					●	●						●					
									●					●	●						●					
									●					●	●						●					
									●					●	●						●					
									●					●	●						●					
									●					●	●						●					
									●					●	●						●					
									●					●	●						●					
									●					●	●						●					
									●					●	●						●					
									●					●	●						●					
									●					●	●						●					
									●					●	●						●					
									●					●	●						●					
									●					●	●						●					
									●					●	●						●					

Cable exit direction

Models A1, A2, and A3

Applicable models

RCP2 / RCP2W-RA10C RCS2-RA5C / RA5R / SRA7BD

Description

Specify this option when you wish to change the direction from which the actuator cable is taken out.

Actuator cable taken out from motor side (standard)

Option not specified (blank)

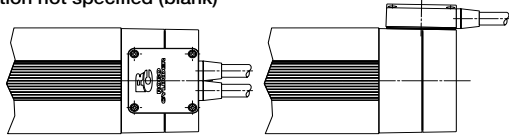

Actuator cable taken out from left

Option specified: **A1** (SRA7BD-compatible)

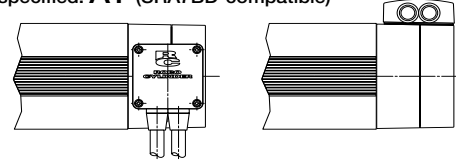

Actuator cable taken out from rod side

Option specified: **A2** (RA5C/RA5R/SRA7BD-compatible)

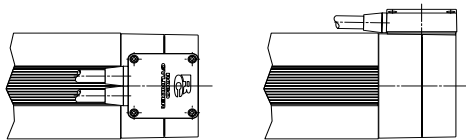

Actuator cable taken out from right

Option specified: **A3** (SRA7BD-compatible)

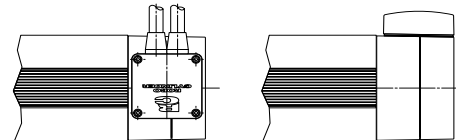

Brake

Models B, BE, BL and BR

Applicable models

All slider-type models (excluding RCP3-SA2A□ / SA2B□ and RCP2-BA6 / BA7)
 All rod-type models (excluding RCP2-RA2C / RA3C, RCA2-RN□N, RP□N, GS□N, GD□N, SD□N and RCA / RCS2 built-in types)
 All table-type models (excluding TC□N, TW□N and TF□N)
 All arm-type and flat-type models (the arm type is a standard feature)
 Linear Servo Rod type
 All cleanroom type models
 Dust-proof / Splash-proof type (excluding RCP2W-SA16C, RCAW-RA3 / 4D and RCS2W-RA4D)

Description

A retention mechanism used on an actuator positioned vertically to prevent the slider from dropping and damaging the part, etc., when the power or servo is turned off.

Cable exit direction

Models CJT, CJR, CJL, CJB and CJO

Applicable models

RCP3 (RCA2)-SA3C / SA4C / SA5C / SA6C / SA3R / SA4R / SA5R / SA6R
 RCP3 (RCA2)-TA4C / TA5C / TA6C / TA7C / TA4R / TA5R / TA6R / TA7R

Description

The direction of the motor-encoder cable mounted on the actuator can be changed vertically or horizontally.

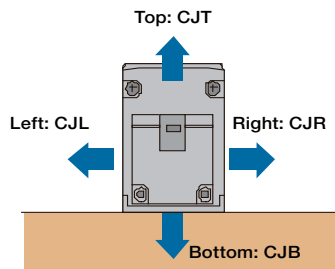

Straight Type

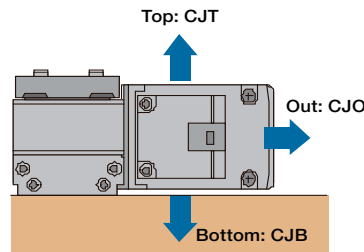

Side-Mounted Motor Type
Mounted on left side (ML)

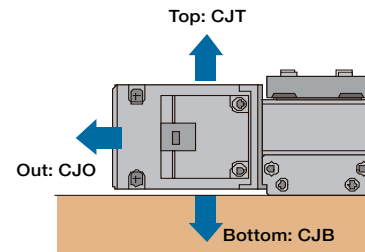

Side-Mounted Motor Type
Mounted on right side (MR)

Front flange

■ Models FL

Applicable models	All rod type models (excluding RCP3 and RCA2)
Description	A bracket for affixing the actuator using bolts from the actuator side.

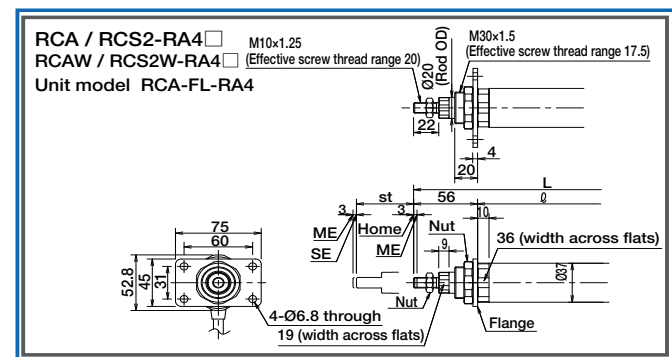
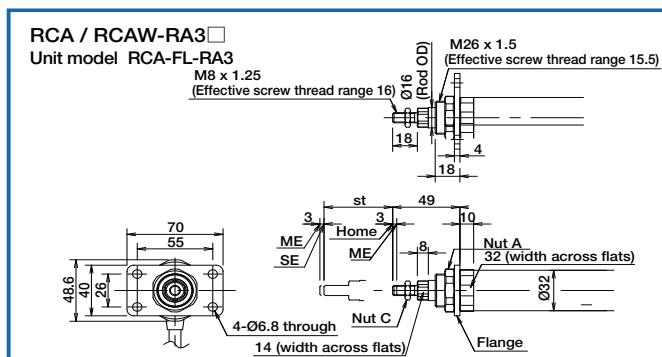
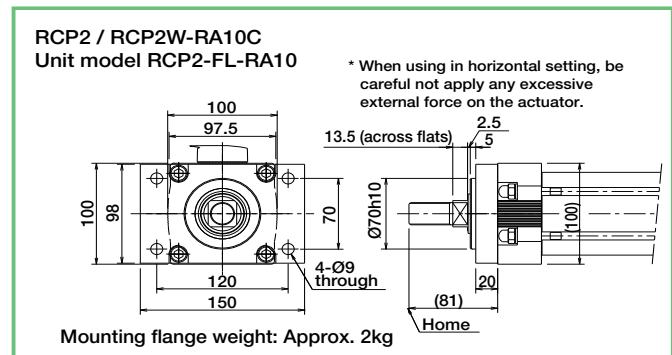
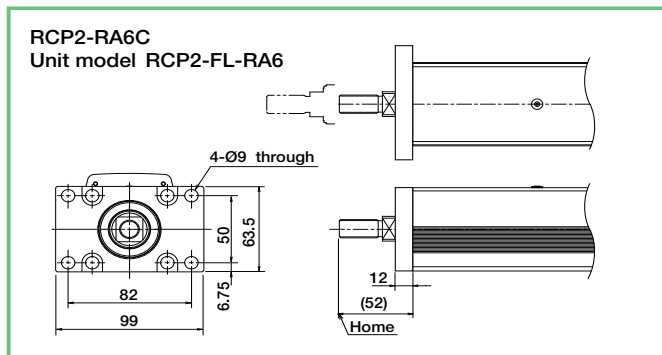
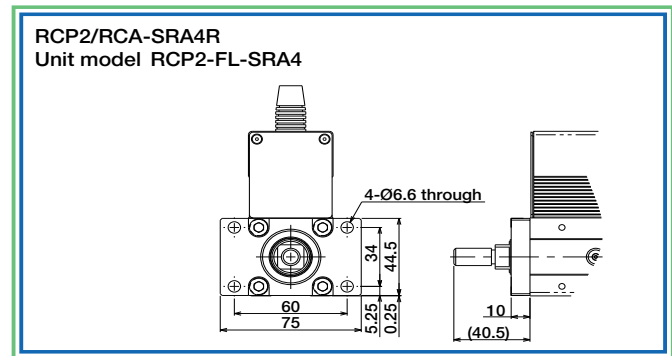
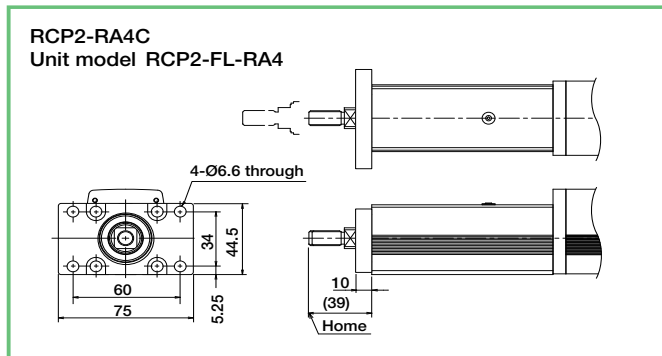
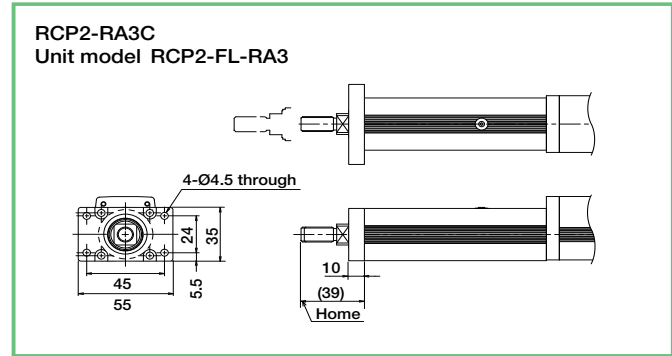
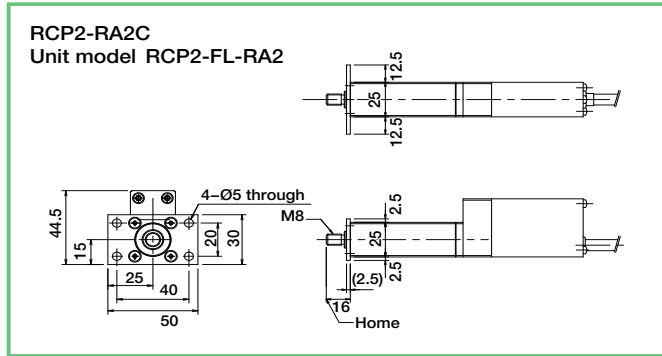

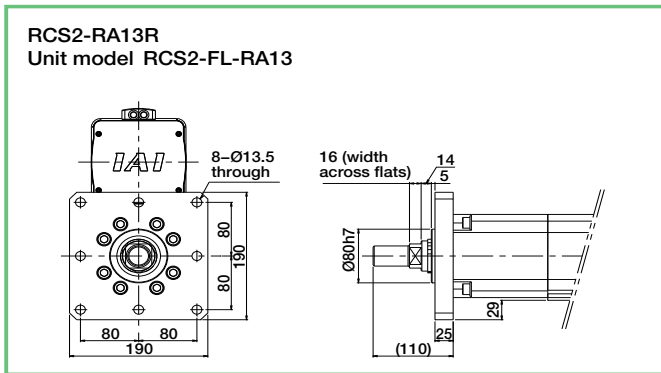
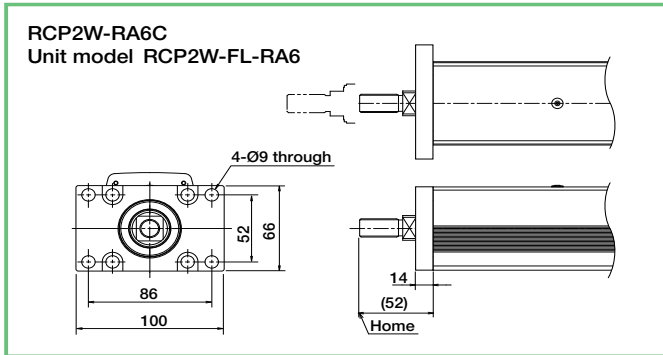
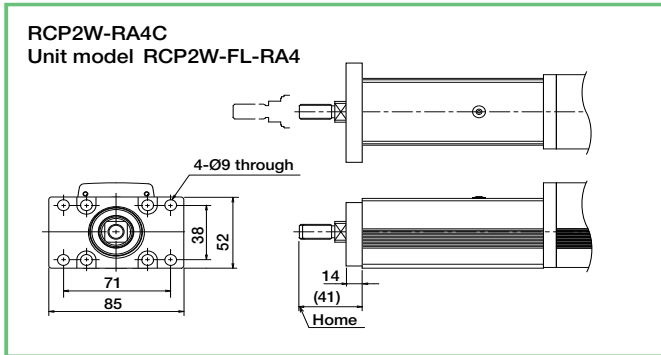
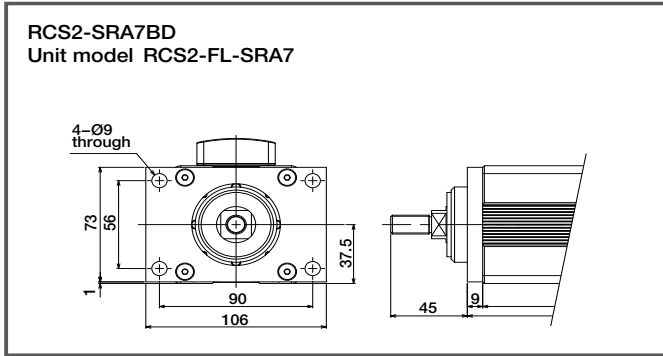
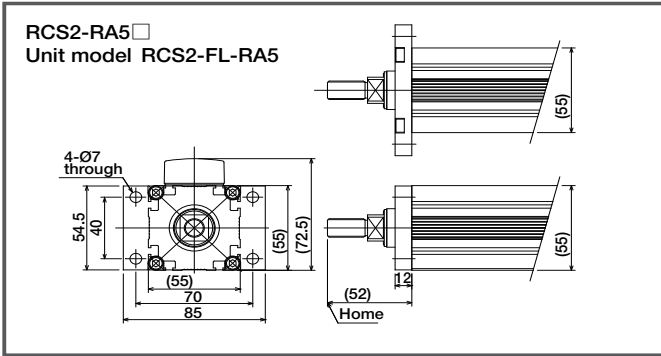

Rear flange

■ Models FLR

Applicable models	RCP2-SRA4R RCA (RCAW)-RA3C / RA3D / RA3R / RA4C / RA4D / RA4R / SRA4R RCS2 (RCS2W)-RA4C / RA4D / RA4R
Description	A bracket to fix a rod-type actuator on the rear (motor side).

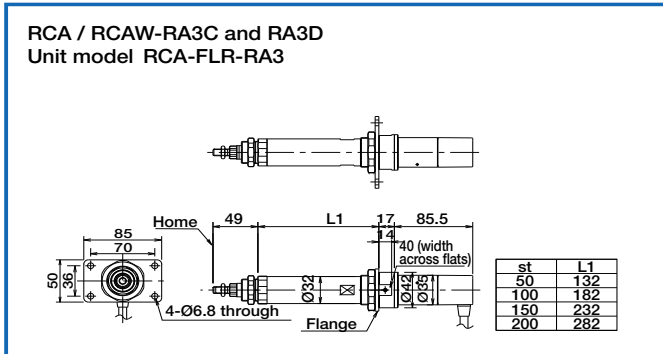
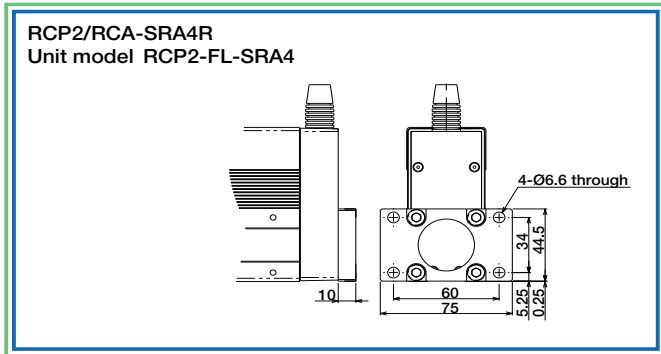

ERC2-RA7C / RGS7C / RGD7C
Unit model ERC2-FT-RA7

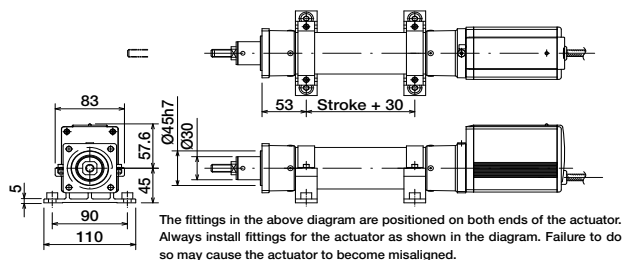

RCP2-RA2C
Unit model RCP2-FT-RA2

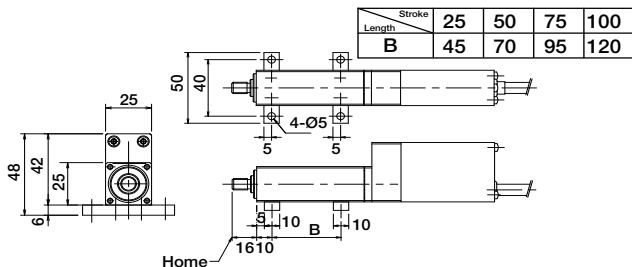

RCP2-RA3C / RGD3C
Unit model RCP2-FT-RA3

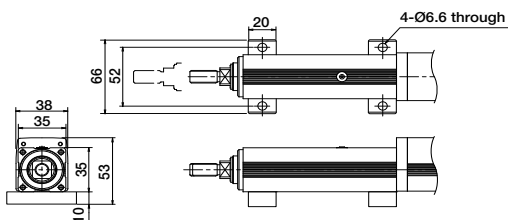

RCP2-RA4C / RGS4C / RGD4C / RCP2W-RA4C
Unit model RCP2-FT-RA4

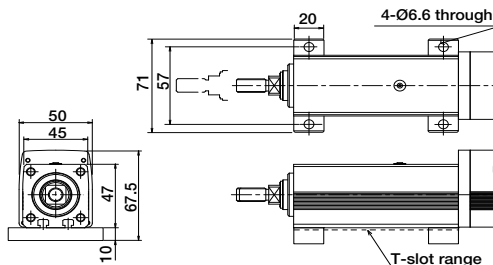

RCP2-RA6C / RGS6C / RGD6C / RCP2W-RA6C
Unit model RCP2-FT-RA6

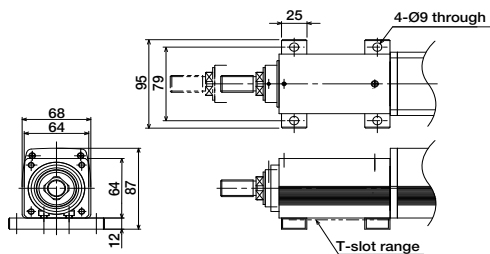

RCP2-RA10C / RCP2W-RA10C
Unit model RCP2-FT-RA10

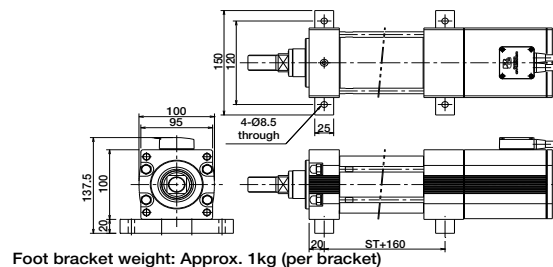

RCP2 / RCA-SRA4R
Unit model RCP2-FT-SRA4

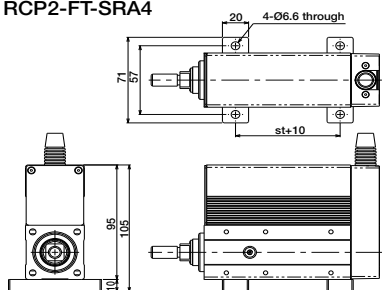

RCA-RA3C / RGS3C / RGD3C
Unit model RCA-FT-RA3

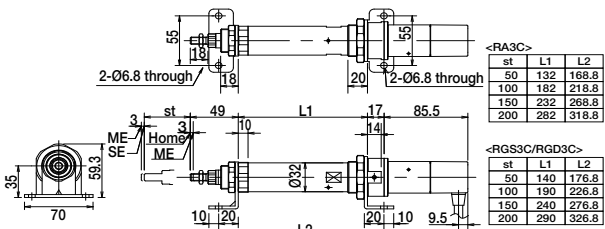

RCA (RCS2)-RA4C / RGS4C / RGD4C
Unit model RCA-FT-RA4

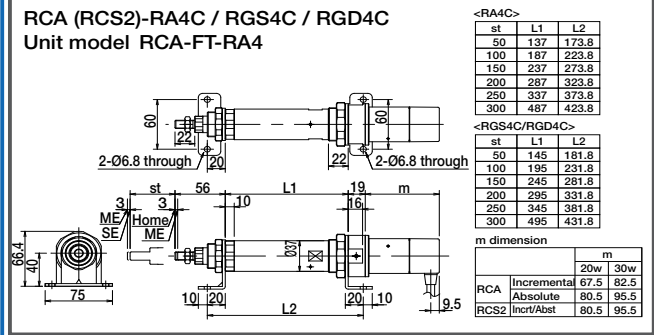

RCA / RA3R / RGS3R / RGD3R
Unit model RCA-FT-RA3R

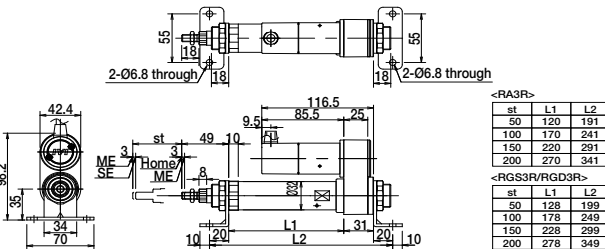

RCA (RCS2)-RA4R / RGS4R / RGD4R
Unit model RCA-FT-RA4R

2-Ø6.8 through

2-Ø6.8 through

50.5
113.2
40
75
39
75

ME
SE
3
st
56
Nut A
10
9.5
115.5
82.5
26
Ø37
L1
33
20
10

<RA4R>		
st	L1	L2
50	125	198
100	175	248
150	225	298
200	275	348
250	325	398
300	375	448

<RGS4R/RGD4R>		
st	L1	L2
50	133	206
100	183	256
150	233	306
200	283	356
250	333	406
300	383	456

RCS2-RA5C / RA5R / RGS5C / RGD5C
Unit model RCS2-FT-RA5

20

80
68

55

4-Ø7 through

55
84.5
12

RCS2-SRA7BD
Unit model RCS2-FT-SRA7

4x2-Ø7 through

100
88

75

20

16.5

75
75
15
107

RCS2-RA13R
Unit model RCS2-FT-RA13

D-13.5 through

160
190

35
A
Bx100
P
C

311

st	A	B	C	D
50	40	2	42.5	6
100	65	2	67.5	6
150	40	3	42.5	8
200	65	3	67.5	8

Foot (Mounted on right side face/left side face)

- Models FT2 (Mounted on right side face)
- FT4 (Mounted on right side face)

Applicable models RCP2 (RCA)-SRA4R

Description A bracket for affixing the actuator using bolts from the top side. RCP2(RCA)-SRA4R can be mounted on the side face also.

RCP2 / RCA-SRA4R
Unit model RCP2-FTS-SRA4

4-Ø6.6 through

20

121
107

st+10

10
45
55

Guide mounting direction (for single-guide type only)

■ Models GS2, GS3 and GS4

Applicable models	RCP2 (RCA)-SRGS4R RCS2-RGS5C / SRA7BD
Description	For the single-guide model, the mounting position of the rod can be selected from the right (GS2), bottom (GS3), or left side (GS4).

High acceleration/deceleration

■ Models HA

Applicable models	RCA-SA4C / SA5C / SA6C / RA3C / RA4C RCS2-SA4C / SA5C / SA6C / SA7C / RA4C / RA5C
Description	Option to increase to 1G the standard acceleration rate of 0.3G. An actuator with 1G of acceleration can be operated with the same load capacity as the 0.3G unit. The controller settings are different from the standard specification, so when operating with high acceleration, the controller also needs to be set to the high acceleration specification.

Home check sensor

■ Models HS

Applicable models	Slider Type	RCA (RCACR)-SA4C / SA5C / SA6C, RCS2 (RCS2CR)-SA4C / SA5C / SA6C RCA-SA4R / SA5R / SA6R and RCS2-SA4R / SA5R / SA6R
	Rod Type	RCA-RA3C / RA3D / RA3R / RA4C / RA4D / RA4R and RCS2-RA4C / RA4D / RA4R
Description	When an actuator is instructed to return home, this sensor checks to make sure that the slider moves to the home position. * This cannot be used with the reversed-home specification for rod types.	

Connector cable exit direction

■ Models K2

Applicable models	RCA2-RN□□ / RP□□ / GS□□ / GD□□ / TC□□ / TW□□ / TF□□
Description	Connector cable outlet direction can be changed from the front to the rear.

Limit switch

■ Models L

Applicable models	Rotary Type RCS2-RT6 / RT6R / RT7R
Description	When home return is performed, the home will be determined after the actuator reverses following contact with the mechanical end. This optional sensor is used to detect this reversing.(However, with the rotary type, all models will have the standard settings.)

Low power compatible

■ Models LA

Applicable models	RCA / RCA2 / RCACR / RCA Series, all models
Description	This option decreases the power capacity of the controller. With the standard specification and high-speed acceleration specification, the maximum is 5.1A, but if the low-power specification is selected, the maximum decreases to 3.4A. (The maximum values differ for some models, so see the power capacities of the ACON/ASEL controllers for details.)

Side-Mounted Motor Orientation

■ Models MB, ML, MR and MT

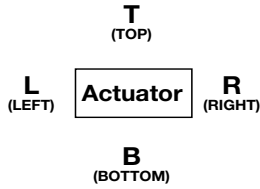

Applicable models All side-mounted motor type models

Description These abbreviations specify the motor reversing direction of the motor reversing type. Viewed from the motor side, downward reversing is MB (arm type only), leftward reversing is ML (all models), rightward reversing is MR (all models), and upward reversing is MT (limited to RCS2-RA13R). The arm type is MB, but for other models, ML is standard. (MT has different criteria for RCS2-RA13R.)

No cover

■ Models NCO

Applicable models RCP3 (RCA2)-SA3C / SA4C / SA5C / SA6C / SA3R / SA4R / SA5R / SA6R

Description By removing the cover from the actuator, the cost reduction can be achieved and the maintainability can be enhanced.

Reversed-home specification

■ Models NM

Applicable models All slider-type models
 All rod-type, table-type, arm-type, and flat-type models
 (* excluding RCP2-RA2C / SRA4R / RA10C, RCA2-RN / RP / GS / GD / SD / TC / TW / TF□N, RCA-SRA4R and RCS2-RA5C / RA5R / SRA7BD / RA13R)

Description The normal home position is set by the slider and rod on the motor side, but there is the option for the home position to be on the other side to accommodate variations in device layout, etc. (Note: Home position settings are factory settings. Changes to these settings after the product is delivered will require shipping the product back to IAI for re-setting.)

Knuckle joint

■ Models NJ

Applicable models Rod Type RCA-RA3C / RA3D / RA3R / RA4C / RA4D / RA4R
RCS2-RA4C / RA4D / RA4R

Description Clevis or trunnion fittings give rotational freedom of movement for the ends of the actuator rods.

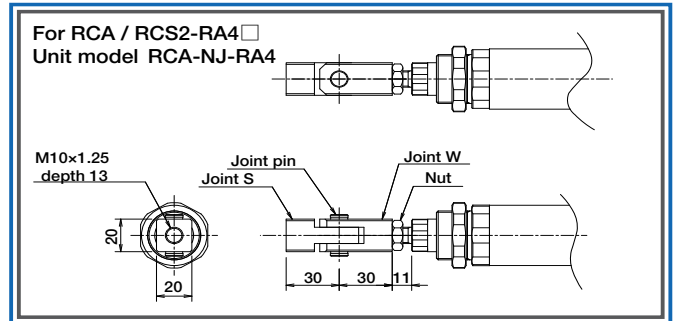
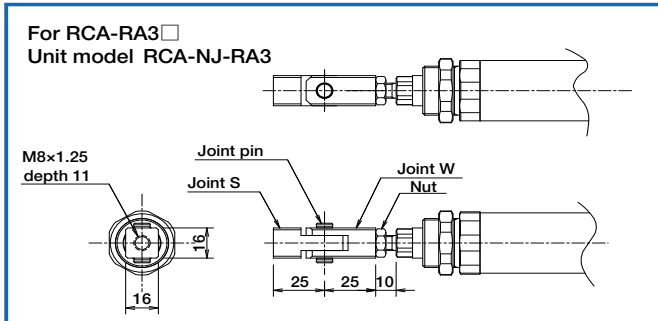

Clevis

■ Models QR

Applicable models Rod Type RCA-RA3R / RA4R
RCS2-RA4R

Description A bracket for aligning the cylinder movement when the load installed at the tip of the rod moves in a direction different from the rod.



Caution

If the rod is to be moved with a clevis bracket attached to it, use a guide type or install an external guide to prevent the rod from receiving any load other than from its moving direction.

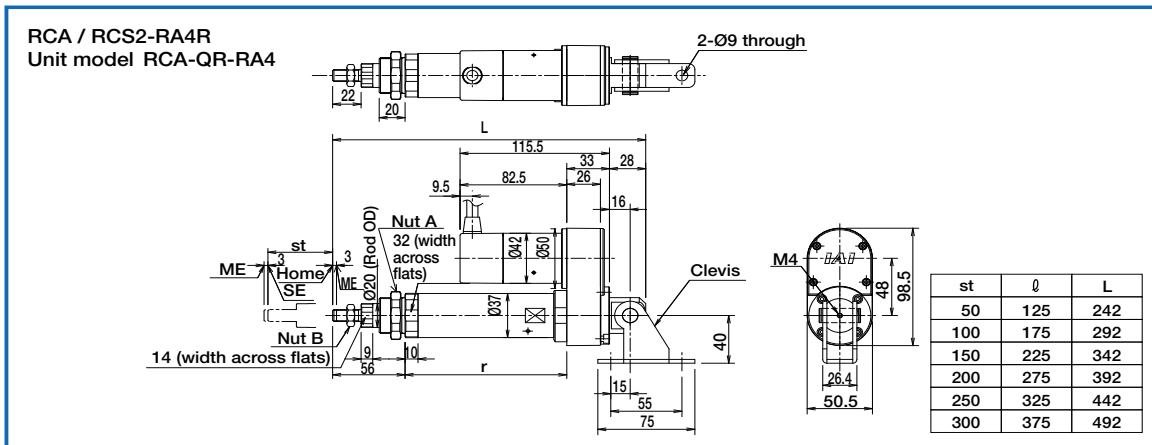
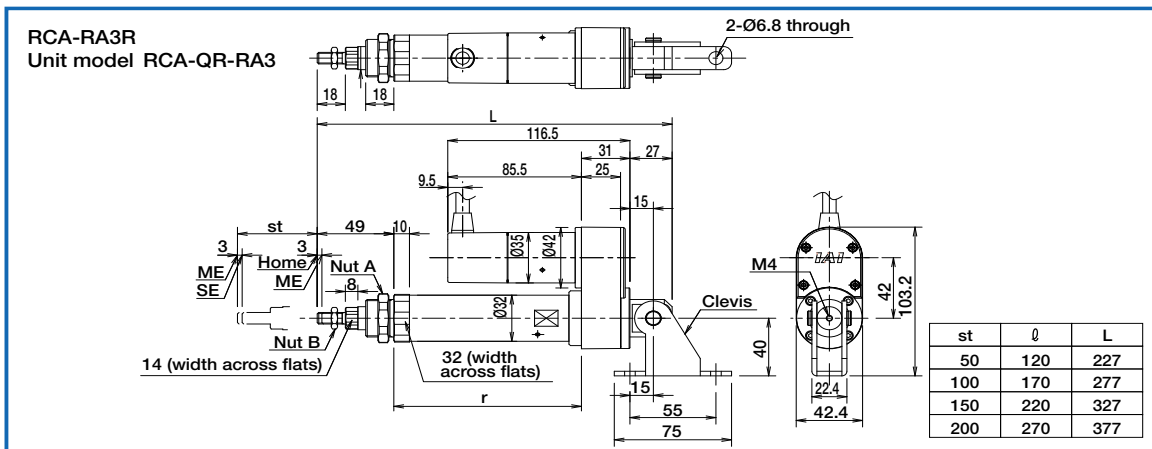

Rod end extension specification

Models RE

Applicable models RCS2-SRA7BD

Description An adapter for extending the rod end so that the distance between the mounting hole and the rod end can be the same as that of RCS2-RA7BD.

Rear mounting plate

Models RP

Applicable models Motor reversing rod types RCA-RA3R / RA4R and RCS2-RA4R

Description A bracket (plate) for affixing the back of a motor-reversing rod type (RA3R/RA4R) to the system.

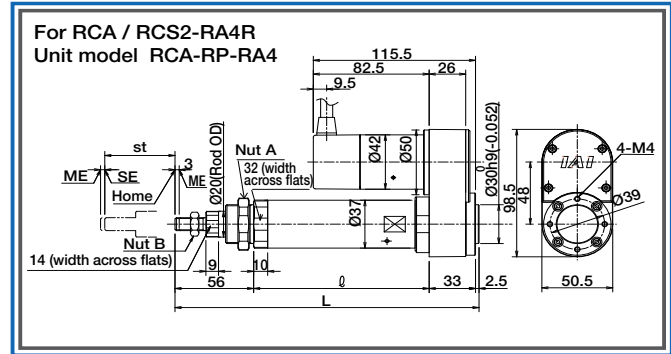
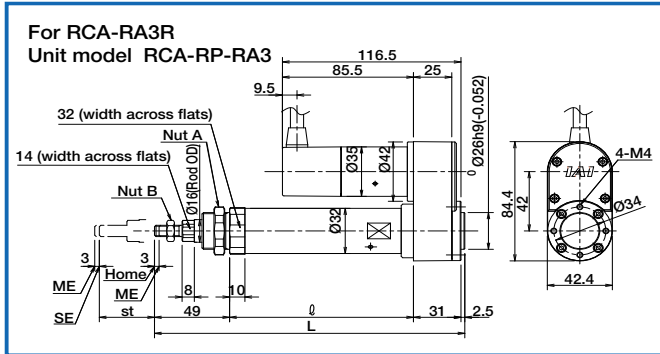

Shaft adapter

Models SA

Applicable models All rotary type models

Description An adapter for installing a jig, etc., onto the rotating part of a rotary type.

RTBS/RTBSL/RTCS/RTCSL

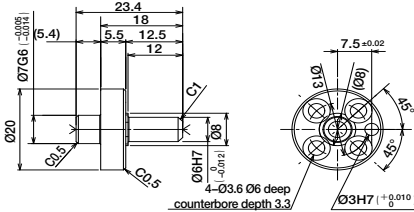

RTB/RTBL/RTC/RTCL

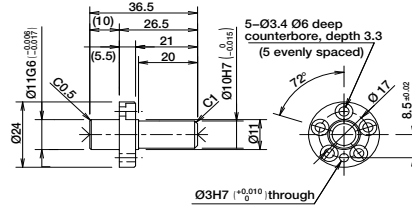

RTBB/RTBBL/RTCB/RTCBL

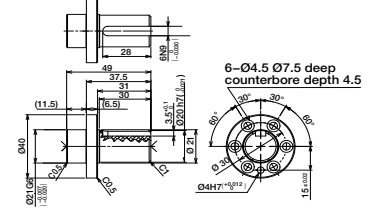

Combined w/ RCP2-RTBS/RTBSL

Configuration: RCP2-SA-RTS
(Weight: 0.02kg)

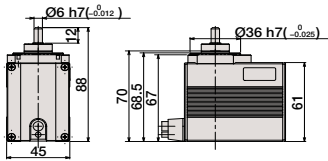

Combined w/ RCP2-RTB/RTBL

Configuration: RCP2-SA-RT
(Weight: 0.04kg)

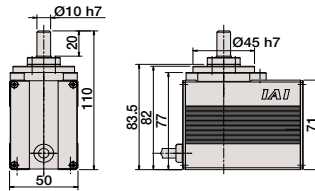

Combined w/ RCP2-RTBB/RTBBL

Configuration: RCP2-SA-RTB (Weight: 0.2kg)

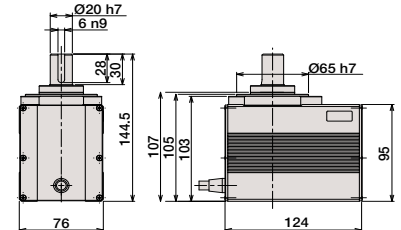

Combined w/ RCP2-RTCS/RTCSL

Configuration: RCP2-SA-RTS
(Weight: 0.02kg)

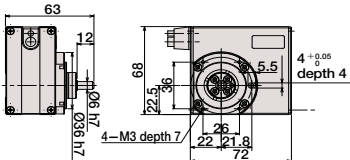

Combined w/ RCP2-RTC/RTCL

Configuration: RCP2-SA-RT
(Weight: 0.04kg)

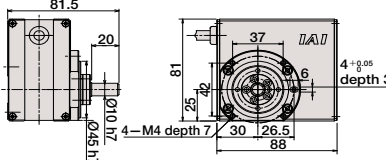

Combined w/ RCP2-RTCB/RTCBL

Configuration: RCP2-SA-RTB
(Weight: 0.2kg)

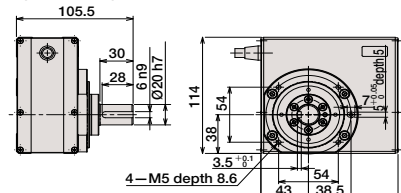

Shaft bracket

■ Models SB

Applicable models Gripper Type RCP2-GRS / GRM / GR3LS
GR3LM / GR3SS / GR3SM

Description This bracket is for mounting the gripper unit.

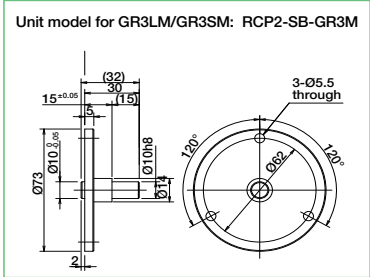
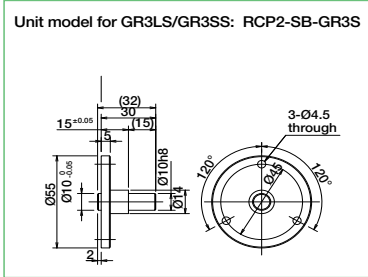
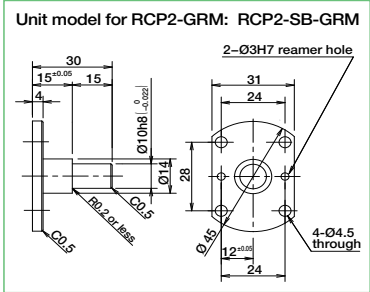
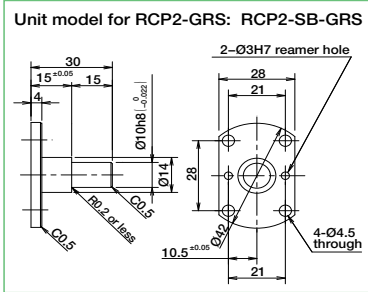

Slider roller specification

■ Models SR

Applicable models Slider type RCA-SA4□/SA5□/SA6□
RCS2-SA4□/SA5□/SA6□/SA7□/SS7□/SS8□

Description This changes the structure of the standard slider type that is similar to those found in cleanroom types.

Slider spacer

■ Models SS

Applicable models Slider Type RCA-SA4C / SA4R
RCS2-SA4C / SA4R

Description A spacer for raising the top face of the slider on the SA4 type to above the motor. This spacer is not required for non-SA4 types because the top face of the slider is above the motor on these actuators.

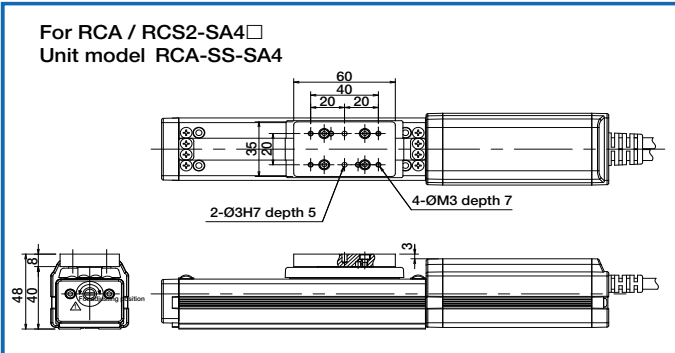

Table adapter

Models TA

Applicable models All rotary type models

Description An adapter for installing a jig, etc., onto the rotating part of a rotary type.

RTBS/RTBSL/RTCS/RTCSL

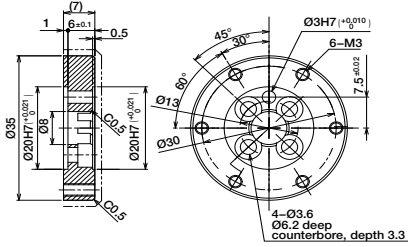

RTB/RTBL/RTC/RTCL

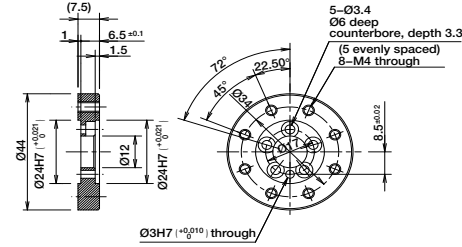

RTBB/RTBBL/RTCB/RTCBL

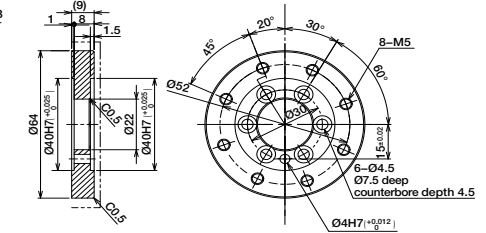

Combined w/ RCP2-RTBS/RTBSL

Configuration: RCP2-TA-RTS
(Weight: 0.02kg)

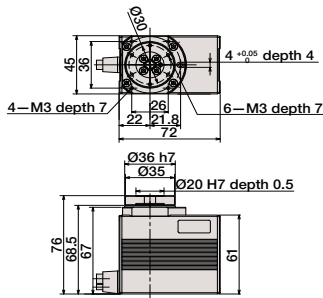

Combined w/ RCP2-RTB/RTBL

Configuration: RCP2-TA-RT
(Weight: 0.03kg)

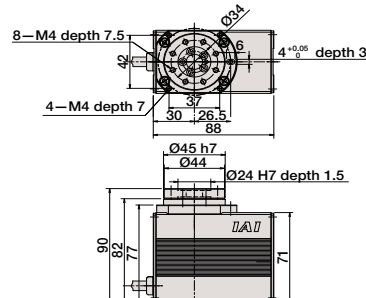

Combined w/ RCP2-RTBB/RTBBL

Configuration: RCP2-TA-RTB
(Weight: 0.06kg)

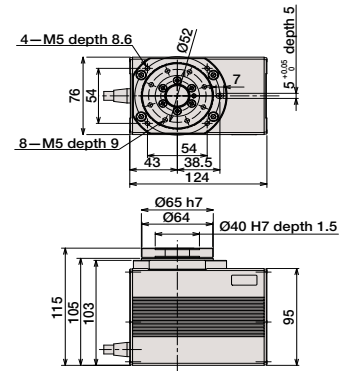

Combined w/ RCP2-RTCS/RTCSL

Configuration: RCP2-TA-RTS
(Weight: 0.02kg)

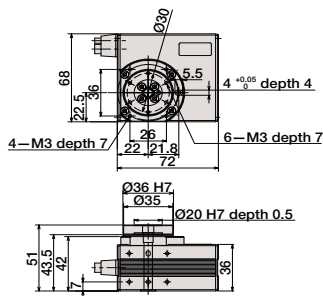

Combined w/ RCP2-RTC/RTCL

Configuration: RCP2-TA-RT
(Weight: 0.03kg)

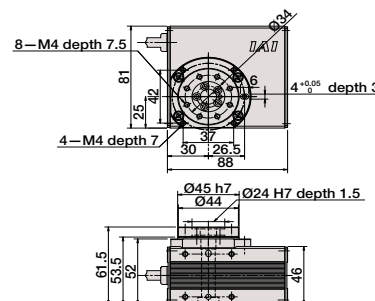

Combined w/ RCP2-RTCB/RTCBL

Configuration: RCP2-TA-RTB
(Weight: 0.06kg)

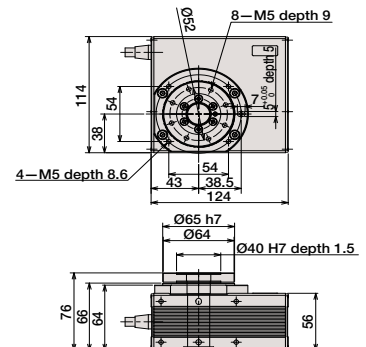

Front trunnion

■ Models TRF

Applicable models

Rod Type RCA-RA3C / RA3D / RA3R / RA4C / RA4D / RA4R
RCS2-RA4C / RA4D / RA4R

Description

A bracket for aligning the cylinder movement when the load installed at the tip of the rod moves in a direction different from the rod.



Caution

If a rod is moved with a trunnion bracket mounted to it, use a guide type or install an external guide so no load is applied to the rod in a direction other than the proper direction the rod travels.

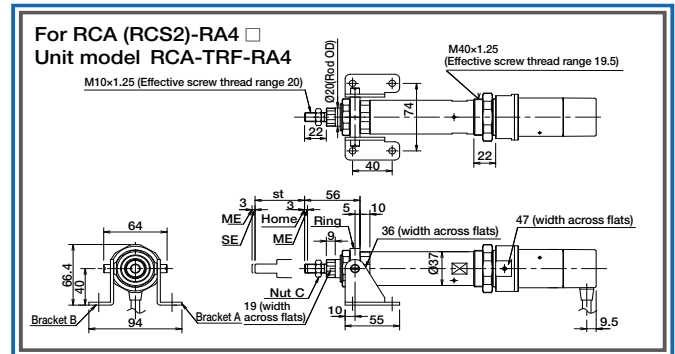
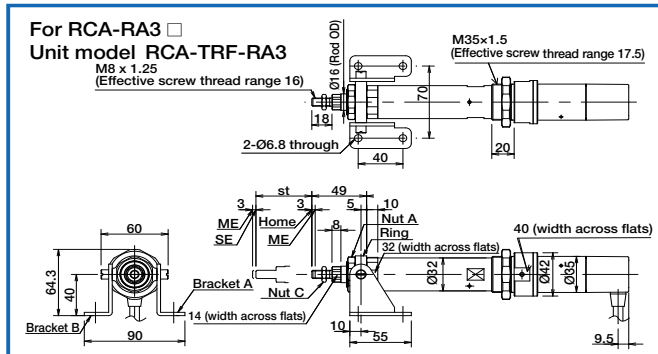

Rear trunnion

■ Models TRR

Applicable models

Rod Type RCA-RA3C / RA3D / RA4C / RA4D
RCS2-RA4C / RA4D

Description

A bracket for aligning the cylinder movement when the load installed at the tip of the rod moves in a direction different from the rod.



Caution

If a rod is moved with a trunnion bracket mounted to it, use a guide type or install an external guide so no load is applied to the rod in a direction other than the proper direction the rod travels.

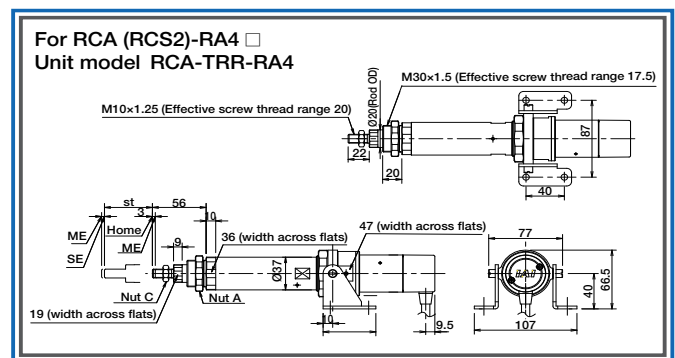
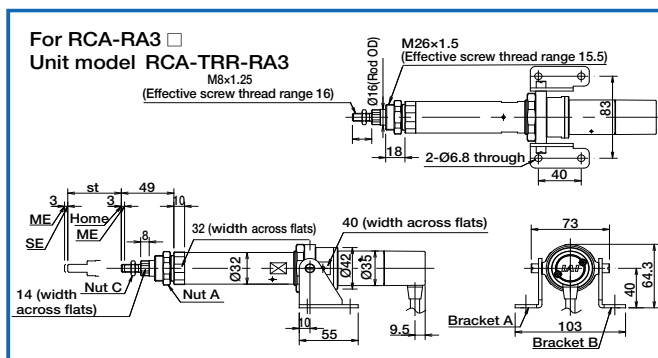

Vacuum joint mounted on opposite side

■ Models VR

Applicable models

All cleanroom type models

Description

Looking from the motor side, the standard position for the vacuum joint is on the left side of the actuator, but this option allows users to change the position to the opposite side (right side).